

* required information

Section 1 of 21

You can save the form at any time and resume it later. You do not need to be logged in when you resume.

System reference

Not Currently In Use

This is the unique reference for this application generated by the system.

Your reference

GLL's Premises Licence Application

You can put what you want here to help you track applications if you make lots of them. It is passed to the authority.

Are you an agent acting on behalf of the applicant?

Yes No

Put "no" if you are applying on your own behalf or on behalf of a business you own or work for.

Applicant Details

* First name

Viktar

* Family name

Maksimuk

* E-mail

assel@frc-group.co.uk

Main telephone number

[REDACTED]

Include country code.

Other telephone number

[REDACTED]

Indicate here if you would prefer not to be contacted by telephone

Are you:

- Applying as a business or organisation, including as a sole trader
 Applying as an individual

A sole trader is a business owned by one person without any special legal structure. Applying as an individual means you are applying so you can be employed, or for some other personal reason, such as following a hobby.

Applicant Business

Is your business registered in the UK with Companies House?

Yes No

Note: completing the Applicant Business section is optional in this form.

Registration number

10988035

Business name

Green's Loughton Ltd

If your business is registered, use its registered name.

VAT number

GB

307527509

Put "none" if you are not registered for VAT.

Legal status

Private Limited Company

Continued from previous page...

Your position in the business

Home country

The country where the headquarters of your business is located.

Registered Address

Address registered with Companies House.

Building number or name

Street

District

City or town

County or administrative area

Postcode

Country

Section 2 of 21

PREMISES DETAILS

I/we, as named in section 1, apply for a premises licence under section 17 of the Licensing Act 2003 for the premises described in section 2 below (the premises) and I/we are making this application to you as the relevant licensing authority in accordance with section 12 of the Licensing Act 2003.

Premises Address

Are you able to provide a postal address, OS map reference or description of the premises?

Address OS map reference Description

Postal Address Of Premises

Building number or name

Street

District

City or town

County or administrative area

Postcode

Country

Further Details

Telephone number

Non-domestic rateable value of premises (£)

Section 3 of 21**APPLICATION DETAILS**

In what capacity are you applying for the premises licence?

- An individual or individuals
- A limited company / limited liability partnership
- A partnership (other than limited liability)
- An unincorporated association
- Other (for example a statutory corporation)
- A recognised club
- A charity
- The proprietor of an educational establishment
- A health service body
- A person who is registered under part 2 of the Care Standards Act 2000 (c14) in respect of an independent hospital in Wales
- A person who is registered under Chapter 2 of Part 1 of the Health and Social Care Act 2008 in respect of the carrying on of a regulated activity (within the meaning of that Part) in an independent hospital in England
- The chief officer of police of a police force in England and Wales

Confirm The Following

- I am carrying on or proposing to carry on a business which involves the use of the premises for licensable activities
- I am making the application pursuant to a statutory function
- I am making the application pursuant to a function discharged by virtue of Her Majesty's prerogative

Section 4 of 21**NON INDIVIDUAL APPLICANTS**

Provide name and registered address of applicant in full. Where appropriate give any registered number. In the case of a partnership or other joint venture (other than a body corporate), give the name and address of each party concerned.

Non Individual Applicant's Name

Name

Green`s Loughton Ltd
t/a Green`s Steakhouse & Grill

Details

Registered number (where applicable)

10988035

Description of applicant (for example partnership, company, unincorporated association etc)

Continued from previous page...

Company

Address

Building number or name

Street

District

City or town

County or administrative area

Postcode

Country

Contact Details

E-mail

Telephone number

Other telephone number

* Date of birth / /
dd mm yyyy

* Nationality

Documents that demonstrate entitlement to work in the UK

Section 5 of 21

OPERATING SCHEDULE

When do you want the premises licence to start? / /
dd mm yyyy

If you wish the licence to be valid only for a limited period, when do you want it to end / /
dd mm yyyy

Provide a general description of the premises

For example the type of premises, its general situation and layout and any other information which could be relevant to the licensing objectives. Where your application includes off-supplies of alcohol and you intend to provide a place for consumption of these off-supplies you must include a description of where the place will be and its proximity to the premises.

Ground floor restaurant of approximately 200 square meters with open plan kitchen and seating capacity of up to 120 customers.

We also plan to have outdoors space in front of the restaurant as shown on the attached plan with seating capacity of up to 34 customers, subject to obtaining further required approvals to put tables and chairs within that outdoors space. The

Continued from previous page...

outdoors area will not be used after 23:00, therefore all licensable activities permitted within the outdoors area will stop at 23:00 daily.

If 5,000 or more people are expected to attend the premises at any one time, state the number expected to attend

Section 6 of 21

PROVISION OF PLAYS

See guidance on regulated entertainment

Will you be providing plays?

- Yes No

Section 7 of 21

PROVISION OF FILMS

See guidance on regulated entertainment

Will you be providing films?

- Yes No

Section 8 of 21

PROVISION OF INDOOR SPORTING EVENTS

See guidance on regulated entertainment

Will you be providing indoor sporting events?

- Yes No

Section 9 of 21

PROVISION OF BOXING OR WRESTLING ENTERTAINMENTS

See guidance on regulated entertainment

Will you be providing boxing or wrestling entertainments?

- Yes No

Section 10 of 21

PROVISION OF LIVE MUSIC

See guidance on regulated entertainment

Will you be providing live music?

- Yes No

Standard Days And Timings

MONDAY

Start

End

Start

End

Give timings in 24 hour clock. (e.g., 16:00) and only give details for the days of the week when you intend the premises to be used for the activity.

Continued from previous page...

TUESDAY

Start	<input type="text" value="11:00"/>	End	<input type="text" value="00:00"/>
Start	<input type="text"/>	End	<input type="text"/>

WEDNESDAY

Start	<input type="text" value="11:00"/>	End	<input type="text" value="00:00"/>
Start	<input type="text"/>	End	<input type="text"/>

THURSDAY

Start	<input type="text" value="11:00"/>	End	<input type="text" value="00:00"/>
Start	<input type="text"/>	End	<input type="text"/>

FRIDAY

Start	<input type="text" value="11:00"/>	End	<input type="text" value="00:00"/>
Start	<input type="text"/>	End	<input type="text"/>

SATURDAY

Start	<input type="text" value="11:00"/>	End	<input type="text" value="00:00"/>
Start	<input type="text"/>	End	<input type="text"/>

SUNDAY

Start	<input type="text" value="11:00"/>	End	<input type="text" value="00:00"/>
Start	<input type="text"/>	End	<input type="text"/>

Will the performance of live music take place indoors or outdoors or both?

- Indoors Outdoors Both

Where taking place in a building or other structure tick as appropriate. Indoors may include a tent.

State type of activity to be authorised, if not already stated, and give relevant further details, for example (but not exclusively) whether or not music will be amplified or unamplified.

Amplified live music.

State any seasonal variations for the performance of live music

For example (but not exclusively) where the activity will occur on additional days during the summer months.

Non-standard timings. Where the premises will be used for the performance of live music at different times from those listed in the column on the left, list below

Continued from previous page...

For example (but not exclusively), where you wish the activity to go on longer on a particular day e.g. Christmas Eve.

Section 11 of 21

PROVISION OF RECORDED MUSIC

See guidance on regulated entertainment

Will you be providing recorded music?

Yes No

Standard Days And Timings

MONDAY

Start

End

Start

End

Give timings in 24 hour clock.
(e.g., 16:00) and only give details for the days
of the week when you intend the premises
to be used for the activity.

TUESDAY

Start

End

Start

End

WEDNESDAY

Start

End

Start

End

THURSDAY

Start

End

Start

End

FRIDAY

Start

End

Start

End

SATURDAY

Start

End

Start

End

SUNDAY

Start

End

Start

End

Will the playing of recorded music take place indoors or outdoors or both?

Indoors Outdoors Both

Where taking place in a building or other
structure tick as appropriate. Indoors may
include a tent.

Continued from previous page...

State type of activity to be authorised, if not already stated, and give relevant further details, for example (but not exclusively) whether or not music will be amplified or unamplified.

Amplified background recorded music.

State any seasonal variations for playing recorded music

For example (but not exclusively) where the activity will occur on additional days during the summer months.

Non-standard timings. Where the premises will be used for the playing of recorded music at different times from those listed in the column on the left, list below

For example (but not exclusively), where you wish the activity to go on longer on a particular day e.g. Christmas Eve.

Non-standard timings: Sale of alcohol, Playing recorded music, Provision of late night refreshments and Opening hours to be:

(1) From the end of permitted hours on Christmas Eve to the start of permitted hours on Christmas Day; and

(2) From the end of permitted hours on New Year's Eve to the start of permitted hours on New Year's Day.

Section 12 of 21

PROVISION OF PERFORMANCES OF DANCE

See guidance on regulated entertainment

Will you be providing performances of dance?

Yes

No

Section 13 of 21

PROVISION OF ANYTHING OF A SIMILAR DESCRIPTION TO LIVE MUSIC, RECORDED MUSIC OR PERFORMANCES OF DANCE

See guidance on regulated entertainment

Will you be providing anything similar to live music, recorded music or performances of dance?

Yes

No

Section 14 of 21

LATE NIGHT REFRESHMENT

Will you be providing late night refreshment?

Yes

No

Standard Days And Timings

Continued from previous page...

MONDAY

Start

End

Give timings in 24 hour clock.
(e.g., 16:00) and only give details for the days
of the week when you intend the premises
to be used for the activity.

Start

End

TUESDAY

Start

End

Start

End

WEDNESDAY

Start

End

Start

End

THURSDAY

Start

End

Start

End

FRIDAY

Start

End

Start

End

SATURDAY

Start

End

Start

End

SUNDAY

Start

End

Start

End

Will the provision of late night refreshment take place indoors or outdoors or both?

Indoors Outdoors Both

Where taking place in a building or other structure tick as appropriate. Indoors may include a tent.

State type of activity to be authorised, if not already stated, and give relevant further details, for example (but not exclusively) whether or not music will be amplified or unamplified.

State any seasonal variations

For example (but not exclusively) where the activity will occur on additional days during the summer months.

Continued from previous page...

Non-standard timings. Where the premises will be used for the supply of late night refreshments at different times from those listed in the column on the left, list below

For example (but not exclusively), where you wish the activity to go on longer on a particular day e.g. Christmas Eve.

Non-standard timings: Sale of alcohol, Playing recorded music, Provision of late night refreshments and Opening hours to be:

(1) From the end of permitted hours on Christmas Eve to the start of permitted hours on Christmas Day; and

(2) From the end of permitted hours on New Year's Eve to the start of permitted hours on New Year's Day.

Section 15 of 21

SUPPLY OF ALCOHOL

Will you be selling or supplying alcohol?

Yes

No

Standard Days And Timings

MONDAY

Start

End

Start

End

Give timings in 24 hour clock.
(e.g., 16:00) and only give details for the days
of the week when you intend the premises
to be used for the activity.

TUESDAY

Start

End

Start

End

WEDNESDAY

Start

End

Start

End

THURSDAY

Start

End

Start

End

FRIDAY

Start

End

Start

End

SATURDAY

Start

End

Start

End

Continued from previous page...

SUNDAY

Start

End

Start

End

Will the sale of alcohol be for consumption:

- On the premises Off the premises Both

If the sale of alcohol is for consumption on the premises select on, if the sale of alcohol is for consumption away from the premises select off. If the sale of alcohol is for consumption on the premises and away from the premises select both.

State any seasonal variations

For example (but not exclusively) where the activity will occur on additional days during the summer months.

Non-standard timings. Where the premises will be used for the supply of alcohol at different times from those listed in the column on the left, list below

For example (but not exclusively), where you wish the activity to go on longer on a particular day e.g. Christmas Eve.

Non-standard timings: Sale of alcohol, Playing recorded music, Provision of late night refreshments and Opening hours to be:

- (1) From the end of permitted hours on Christmas Eve to the start of permitted hours on Christmas Day; and
- (2) From the end of permitted hours on New Year's Eve to the start of permitted hours on New Year's Day.

State the name and details of the individual whom you wish to specify on the licence as premises supervisor

Name

First name

Family name

Date of birth / /
dd mm yyyy

Continued from previous page...

Enter the contact's address

Building number or name	<input type="text"/>
Street	<input type="text"/>
District	<input type="text"/>
City or town	<input type="text"/>
County or administrative area	<input type="text"/>
Postcode	<input type="text"/>
Country	<input type="text" value="United Kingdom"/>
Personal Licence number (if known)	<input type="text" value="046187"/>
Issuing licensing authority (if known)	<input type="text" value="London Borough of Redbridge"/>

PROPOSED DESIGNATED PREMISES SUPERVISOR CONSENT

How will the consent form of the proposed designated premises supervisor be supplied to the authority?

- Electronically, by the proposed designated premises supervisor
- As an attachment to this application

Reference number for consent form (if known)

If the consent form is already submitted, ask the proposed designated premises supervisor for its 'system reference' or 'your reference'.

Section 16 of 21

ADULT ENTERTAINMENT

Highlight any adult entertainment or services, activities, or other entertainment or matters ancillary to the use of the premises that may give rise to concern in respect of children

Give information about anything intended to occur at the premises or ancillary to the use of the premises which may give rise to concern in respect of children, regardless of whether you intend children to have access to the premises, for example (but not exclusively) nudity or semi-nudity, films for restricted age groups etc gambling machines etc.

Section 17 of 21

HOURS PREMISES ARE OPEN TO THE PUBLIC

Standard Days And Timings

Continued from previous page...

MONDAY

Start

End

Start

End

Give timings in 24 hour clock.
(e.g., 16:00) and only give details for the days
of the week when you intend the premises
to be used for the activity.

TUESDAY

Start

End

Start

End

WEDNESDAY

Start

End

Start

End

THURSDAY

Start

End

Start

End

FRIDAY

Start

End

Start

End

SATURDAY

Start

End

Start

End

SUNDAY

Start

End

Start

End

State any seasonal variations

For example (but not exclusively) where the activity will occur on additional days during the summer months.

Non standard timings. Where you intend to use the premises to be open to the members and guests at different times from those listed in the column on the left, list below

For example (but not exclusively), where you wish the activity to go on longer on a particular day e.g. Christmas Eve.

Non-standard timings: Sale of alcohol, Playing recorded music, Provision of late night refreshments and Opening hours to be:

(1) From the end of permitted hours on Christmas Eve to the start of permitted hours on Christmas Day; and

Continued from previous page...

(2) From the end of permitted hours on New Year's Eve to the start of permitted hours on New Year's Day.

Section 18 of 21

LICENSING OBJECTIVES

Describe the steps you intend to take to promote the four licensing objectives:

a) General – all four licensing objectives (b,c,d,e)

List here steps you will take to promote all four licensing objectives together.

- The premises will trade predominantly as a restaurant and substantial food and non-intoxicating drinks shall be available up to one hours before the terminal hour for the sale of alcohol.

b) The prevention of crime and disorder

- Staff training will include details of offences relating to the sale of alcohol to under 18's.
- Digital CCTV and appropriate recording equipment will be installed, operated and maintained throughout the premises. CCTV footage will be stored for a minimum of 31 days.

c) Public safety

- Risk assessment, employee safety, accident report and health and safety policies and manuals will be made available for inspection on site.

d) The prevention of public nuisance

- Staff will be trained to ask customers to leave quietly in the evenings when necessary, and the notice asking customers to leave quietly in the evening when necessary will be displayed within the premises.
- Waiter/waitress services may be provided for external area associated with the premises and used by customers for the consumption of food and drink, subject to obtaining by us required consents, licences and permissions. The area shall not be used after 23:00 hours daily.

e) The protection of children from harm

- All staff involved in the area of supply of alcohol will be trained to ensure there is no sale of alcohol to persons under 18. The premises will operate a Challenge 25 policy. The policy will require any person who appears to be under 25 to produce one of the following forms of identification:

- (a) a full UK photo driving licence;
- (b) passport;
- (c) Military ID card;
- (d) any recognised Proof of Age accreditation under the Proof of Age Standard Scheme (PASS); or
- (e) any other form of ID approved by the Police.

Section 19 of 21

NOTES ON DEMONSTRATING ENTITLEMENT TO WORK IN THE UK

Continued from previous page...

Entitlement to work/immigration status for individual applicants and applications from partnerships which are not limited liability partnerships:

A licence may not be held by an individual or an individual in a partnership who is resident in the UK who:

- does not have the right to live and work in the UK; or
- is subject to a condition preventing him or her from doing work relating to the carrying on of a licensable activity.

Any premises licence issued in respect of an application made on or after 6 April 2017 will become invalid if the holder ceases to be entitled to work in the UK.

Applicants must demonstrate that they have an entitlement to work in the UK and are not subject to a condition preventing them from doing work relating to the carrying on of a licensable activity. They do this in one of two ways: 1) by providing with this application copies or scanned copies of the documents listed below (which do not need to be certified), or 2) by providing their 'share code' to enable the licensing authority to carry out a check using the Home Office online right to work checking service (see below).

Documents which demonstrate entitlement to work in the UK

- An expired or current passport showing the holder, or a person named in the passport as the child of the holder, is a British citizen or a citizen of the UK and Colonies having the right of abode in the UK [please see note below about which sections of the passport to copy].
- An expired or current passport or national identity card showing the holder, or a person named in the passport as the child of the holder, is a national of a European Economic Area country or Switzerland.
- A Registration Certificate or document certifying permanent residence issued by the Home Office to a national of a European Economic Area country or Switzerland.
- A Permanent Residence Card issued by the Home Office to the family member of a national of a European Economic Area country or Switzerland.
- A **current** Biometric Immigration Document (Biometric Residence Permit) issued by the Home Office to the holder indicating that the person named is allowed to stay indefinitely in the UK, or has no time limit on their stay in the UK.
- A **current** passport endorsed to show that the holder is exempt from immigration control, is allowed to stay indefinitely in the UK, has the right of abode in the UK, or has no time limit on their stay in the UK.
- A **current** Immigration Status Document issued by the Home Office to the holder with an endorsement indicating that the named person is allowed to stay indefinitely in the UK or has no time limit on their stay in the UK, **when produced in combination with** an official document giving the person's permanent National Insurance number and their name issued by a Government agency or a previous employer.
- A birth or adoption certificate issued in the UK, **when produced in combination with** an official document giving the person's permanent National Insurance number and their name issued by a Government agency or a previous employer.
- A birth or adoption certificate issued in the Channel Islands, the Isle of Man or Ireland **when produced in combination with** an official document giving the person's permanent National Insurance number and their name issued by a Government agency or a previous employer.
- A certificate of registration or naturalisation as a British citizen, **when produced in combination with** an official document giving the person's permanent National Insurance number and their name issued by a Government agency or a previous employer.

Continued from previous page...

- A **current** passport endorsed to show that the holder is allowed to stay in the UK and is currently allowed to work and is not subject to a condition preventing the holder from doing work relating to the carrying on of a licensable activity.
- A **current** Biometric Immigration Document (Biometric Residence Permit) issued by the Home Office to the holder which indicates that the named person can currently stay in the UK and is allowed to work relation to the carrying on of a licensable activity.
- A **current** Residence Card issued by the Home Office to a person who is not a national of a European Economic Area state or Switzerland but who is a family member of such a national or who has derivative rights or residence.
- A **current** Immigration Status Document containing a photograph issued by the Home Office to the holder with an endorsement indicating that the named person may stay in the UK, and is allowed to work and is not subject to a condition preventing the holder from doing work relating to the carrying on of a licensable activity **when produced in combination with** an official document giving the person's permanent National Insurance number and their name issued by a Government agency or a previous employer.
- A Certificate of Application, **less than 6 months old**, issued by the Home Office under regulation 18(3) or 20(2) of the Immigration (European Economic Area) Regulations 2016, to a person who is not a national of a European Economic Area state or Switzerland but who is a family member of such a national or who has derivative rights of residence.
- Reasonable evidence that the person has an outstanding application to vary their permission to be in the UK with the Home Office such as the Home Office acknowledgement letter or proof of postage evidence, or reasonable evidence that the person has an appeal or administrative review pending on an immigration decision, such as an appeal or administrative review reference number.
- Reasonable evidence that a person who is not a national of a European Economic Area state or Switzerland but who is a family member of such a national or who has derivative rights of residence in exercising treaty rights in the UK including:-
 - evidence of the applicant's own identity – such as a passport,
 - evidence of their relationship with the European Economic Area family member – e.g. a marriage certificate, civil partnership certificate or birth certificate, and
 - evidence that the European Economic Area national has a right of permanent residence in the UK or is one of the following if they have been in the UK for more than 3 months:
 - (i) working e.g. employment contract, wage slips, letter from the employer,
 - (ii) self-employed e.g. contracts, invoices, or audited accounts with a bank,
 - (iii) studying e.g. letter from the school, college or university and evidence of sufficient funds; or
 - (iv) self-sufficient e.g. bank statements.

Family members of European Economic Area nationals who are studying or financially independent must also provide evidence that the European Economic Area national and any family members hold comprehensive sickness insurance in the UK. This can include a private medical insurance policy, an EHIC card or an S1, S2 or S3 form.

Original documents must not be sent to licensing authorities. If the document copied is a passport, a copy of the following pages should be provided:-

- (i) any page containing the holder's personal details including nationality;
- (ii) any page containing the holder's photograph;
- (iii) any page containing the holder's signature;
- (iv) any page containing the date of expiry; and
- (v) any page containing information indicating the holder has permission to enter or remain in the UK and is permitted to work.

Continued from previous page...

If the document is not a passport, a copy of the whole document should be provided.

Your right to work will be checked as part of your licensing application and this could involve us checking your immigration status with the Home Office. We may otherwise share information with the Home Office. Your licence application will not be determined until you have complied with this guidance.

Home Office online right to work checking service

As an alternative to providing a copy of the documents listed above, applicants may demonstrate their right to work by allowing the licensing authority to carry out a check with the Home Office online right to work checking service.

To demonstrate their right to work via the Home Office online right to work checking service, applicants should include in this application their 9-digit share code (provided to them upon accessing the service at <https://www.gov.uk/prove-right-to-work>) which, along with the applicant's date of birth (provided within this application), will allow the licensing authority to carry out the check.

In order to establish the applicant's right to work, the check will need to indicate that the applicant is allowed to work in the United Kingdom and is not subject to a condition preventing them from doing work relating to the carrying on of a licensable activity.

An online check will not be possible in all circumstances because not all applicants will have an immigration status that can be checked online. The Home Office online right to work checking service sets out what information and/or documentation applicants will need in order to access the service. Applicants who are unable to obtain a share code from the service should submit copy documents as set out above.

Section 20 of 21

NOTES ON REGULATED ENTERTAINMENT

Continued from previous page...

In terms of specific **regulated entertainments** please note that:

- Plays: no licence is required for performances between 08:00 and 23.00 on any day, provided that the audience does not exceed 500.
- Films: no licence is required for 'not-for-profit' film exhibition held in community premises between 08.00 and 23.00 on any day provided that the audience does not exceed 500 and the organiser (a) gets consent to the screening from a person who is responsible for the premises; and (b) ensures that each such screening abides by age classification ratings.
- Indoor sporting events: no licence is required for performances between 08.00 and 23.00 on any day, provided that the audience does not exceed 1000.
- Boxing or Wrestling Entertainment: no licence is required for a contest, exhibition or display of Greco-Roman wrestling, or freestyle wrestling between 08.00 and 23.00 on any day, provided that the audience does not exceed 1000. Combined fighting sports – defined as a contest, exhibition or display which combines boxing or wrestling with one or more martial arts – are licensable as a boxing or wrestling entertainment rather than an indoor sporting event.
- Live music: no licence permission is required for:
 - o a performance of unamplified live music between 08.00 and 23.00 on any day, on any premises.
 - o a performance of amplified live music between 08.00 and 23.00 on any day on premises authorised to sell alcohol for consumption on those premises, provided that the audience does not exceed 500.
 - o a performance of amplified live music between 08.00 and 23.00 on any day, in a workplace that is not licensed to sell alcohol on those premises, provided that the audience does not exceed 500.
 - o a performance of amplified live music between 08.00 and 23.00 on any day, in a church hall, village hall, community hall, or other similar community premises, that is not licensed by a premises licence to sell alcohol, provided that (a) the audience does not exceed 500, and (b) the organiser gets consent for the performance from a person who is responsible for the premises.
 - o a performance of amplified live music between 08.00 and 23.00 on any day, at the non-residential premises of (i) a local authority, or (ii) a school, or (iii) a hospital, provided that (a) the audience does not exceed 500, and (b) the organiser gets consent for the performance on the relevant premises from: (i) the local authority concerned, or (ii) the school or (iii) the health care provider for the hospital.
- Recorded Music: no licence permission is required for:
 - o any playing of recorded music between 08.00 and 23.00 on any day on premises authorised to sell alcohol for consumption on those premises, provided that the audience does not exceed 500.
 - o any playing of recorded music between 08.00 and 23.00 on any day, in a church hall, village hall, community hall, or other similar community premises, that is not licensed by a premises licence to sell alcohol, provided that (a) the audience does not exceed 500, and (b) the organiser gets consent for the performance from a person who is responsible for the premises.
 - o any playing of recorded music between 08.00 and 23.00 on any day, at the non-residential premises of (i) a local authority, or (ii) a school, or (iii) a hospital, provided that (a) the audience does not exceed 500, and (b) the organiser gets consent for the performance on the relevant premises from: (i) the local authority concerned, or (ii) the school proprietor or (iii) the health care provider for the hospital.

Continued from previous page...

- Dance: no licence is required for performances between 08.00 and 23.00 on any day, provided that the audience does not exceed 500. However, a performance which amounts to adult entertainment remains licensable.
- Cross activity exemptions: no licence is required between 08.00 and 23.00 on any day, with no limit on audience size for:
 - o any entertainment taking place on the premises of the local authority where the entertainment is provided by or on behalf of the local authority;
 - o any entertainment taking place on the hospital premises of the health care provider where the entertainment is provided by or on behalf of the health care provider;
 - o any entertainment taking place on the premises of the school where the entertainment is provided by or on behalf of the school proprietor; and
 - o any entertainment (excluding films and a boxing or wrestling entertainment) taking place at a travelling circus, provided that (a) it takes place within a moveable structure that accommodates the audience, and (b) that the travelling circus has not been located on the same site for more than 28 consecutive days.

Section 21 of 21

PAYMENT DETAILS

This fee must be paid to the authority. If you complete the application online, you must pay it by debit or credit card.

Premises Licence Fees are determined by the non-domestic rateable value of the premises.

To find out a premises non domestic rateable value go to the Valuation Office Agency site at http://www.voa.gov.uk/business_rates/index.htm

Band A - No RV to £4300 £100.00

Band B - £4301 to £33000 £190.00

Band C - £33001 to £8700 £315.00

Band D - £87001 to £12500 £450.00*

Band E - £125001 and over £635.00*

*If the premises rateable value is in Bands D or E and the premises is primarily used for the consumption of alcohol on the premises then your are required to pay a higher fee

Band D - £87001 to £12500 £900.00

Band E - £125001 and over £1,905.00

There is an exemption from the payment of fees in relation to the provision of regulated entertainment at church halls, chapel halls or premises of a similar nature, village halls, parish or community halls, or other premises of a similar nature. The costs associated with these licences will be met by central Government. If, however, the licence also authorises the use of the premises for the supply of alcohol or the provision of late night refreshment, a fee will be required.

Schools and sixth form colleges are exempt from the fees associated with the authorisation of regulated entertainment where the entertainment is provided by and at the school or college and for the purposes of the school or college.

If you operate a large event you are subject to ADDITIONAL fees based upon the number in attendance at any one time

Capacity 5000-9999 £1,000.00

Capacity 10000 -14999 £2,000.00

Capacity 15000-19999 £4,000.00

Capacity 20000-29999 £8,000.00

Capacity 30000-39000 £16,000.00

Capacity 40000-49999 £24,000.00

Capacity 50000-59999 £32,000.00

Capacity 60000-69999 £40,000.00

Capacity 70000-79999 £48,000.00

Capacity 80000-89999 £56,000.00

Capacity 90000 and over £64,000.00

* Fee amount (£)

315.00

ATTACHMENTS

AUTHORITY POSTAL ADDRESS

Continued from previous page...

Address

Building number or name	<input type="text"/>
Street	<input type="text"/>
District	<input type="text"/>
City or town	<input type="text"/>
County or administrative area	<input type="text"/>
Postcode	<input type="text"/>
Country	<input type="text" value="United Kingdom"/>

DECLARATION

[Applicable to individual applicants only, including those in a partnership which is not a limited liability partnership] I understand I am not entitled to be issued with a licence if I do not have the entitlement to live and work in the UK (or if I am subject to a condition preventing me from doing work relating to the carrying on of a licensable activity) and that my licence will become invalid if I cease to be entitled to live and work in the UK. The DPS named in this application form is entitled to work in the UK (and is not subject to conditions preventing him or her from doing work relating to a licensable activity) and I have seen a copy of his or her proof of entitlement to work, if appropriate

Ticking this box indicates you have read and understood the above declaration

This section should be completed by the applicant, unless you answered "Yes" to the question "Are you an agent acting on behalf of the applicant?"

* Full name	<input type="text"/>
* Capacity	<input type="text"/>
Date (dd/mm/yyyy)	<input type="text"/>

Once you're finished you need to do the following:

1. Save this form to your computer by clicking file/save as...
2. Go back to <https://www.gov.uk/apply-for-a-licence/premises-licence/epping-forest/apply-1> to upload this file and continue with your application.

Don't forget to make sure you have all your supporting documentation to hand.

IT IS AN OFFENCE LIABLE TO SUMMARY CONVICTION TO A FINE OF ANY AMOUNT UNDER SECTION 158 OF THE LICENSING ACT 2003, TO MAKE A FALSE STATEMENT IN OR IN CONNECTION WITH THIS APPLICATION

IT IS AN OFFENCE UNDER SECTION 24B OF THE IMMIGRATION ACT 1971 FOR A PERSON TO WORK WHEN THEY KNOW, OR HAVE REASONABLE CAUSE TO BELIEVE, THAT THEY ARE DISQUALIFIED FROM DOING SO BY REASON OF THEIR IMMIGRATION STATUS. THOSE WHO EMPLOY AN ADULT WITHOUT LEAVE OR WHO IS SUBJECT TO CONDITIONS AS TO EMPLOYMENT WILL BE LIABLE TO A CIVIL PENALTY UNDER SECTION 15 OF THE IMMIGRATION, ASYLUM AND NATIONALITY ACT 2006 AND PURSUANT TO SECTION 21 OF THE SAME ACT, WILL BE COMMITTING AN OFFENCE WHERE THEY DO SO IN THE KNOWLEDGE, OR WITH REASONABLE CAUSE TO BELIEVE, THAT THE EMPLOYEE IS DISQUALIFIED

Consent of individual to being specified as premises supervisor

Bradley Green

[full name of prospective premises supervisor]

of

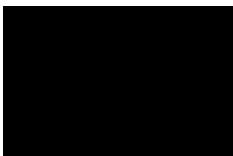

[home address of prospective premises supervisor]

hereby confirm that I give my consent to be specified as the designated premises supervisor in relation to the application for

Premises Licence

[type of application]

by

Green`s Loughton Limited and/or Viktor Maksimuk

[name of applicant]

relating to a premises licence

N/A

[number of existing licence, if any]

for

Green`s Loughton Limited t/a Green`s Steakhouse
3 Centric Parade
200 High Road
Loughton
IG10 1DN

[name and address of premises to which the application relates]

and any premises licence to be granted or varied in respect of this application made by

Viktar Maksimuk

[name of applicant]

concerning the supply of alcohol at

Green's Loughton Limited t/a Greens Steakhouse
3 Centric Parade
200 High Road
Loughton
IG10 1DN

[name and address of premises to which application relates]

I also confirm that I am entitled to work in the United Kingdom and am applying for, intend to apply for or currently hold a personal licence, details of which I set out below.

Personal licence number

046187

[insert personal licence number, if any]

Personal licence issuing authority

London Borough of Redbridge
Licensing Service
Perth Terrace
Ilford, Essex
IG2 6AT
020 8708 5716 and/or

Lynton House
255 - 259 High Road
Ilford
IG1 1NY
020 8554 5000

[insert name and address and telephone number of personal licence issuing authority, if any]

Signed



Name (please print)

Bradley Green

Date

16/09/2019

Scale 1:100

PREMISES PLAN - GREEN'S LOUGHTON LIMITED T/A GREEN'S STEAKHOUSE & GRILL

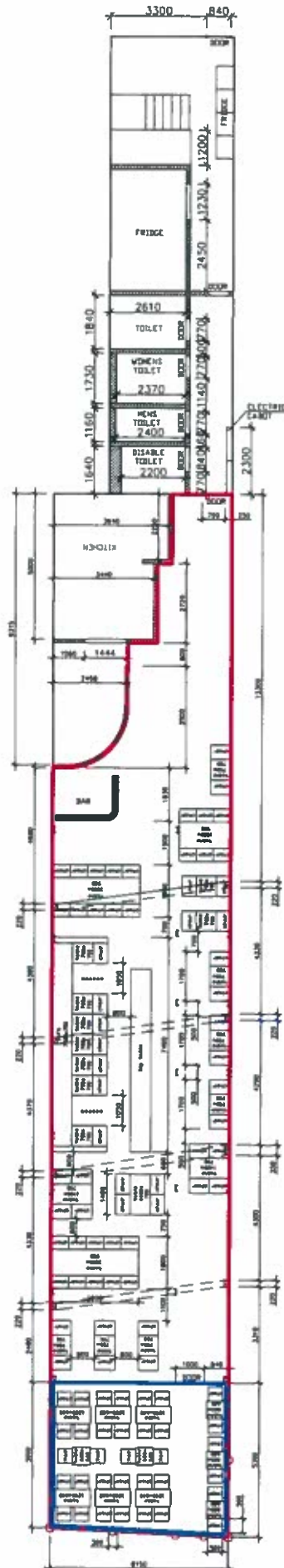

 Licensable Activities

 Outdoors Space

Denise Bastick

From: Assel England <assel@frc-group.co.uk>
Sent: 21 October 2019 11:07
To: Denise Bastick
Cc: Brad Green; Victor Maksimuk
Subject: RE: New Premises Licence Application - Green's Steakhouse, 3 Centric Parade, 200 High Road, Loughton

CAUTION: This Message originated outside of Epping Forest District Council. Do not click links or open attachments unless you recognise the sender and know the contents is safe.

Good Morning,

Thank you for your email. I work part-time Monday to Wednesday with no access to my emails and/or ability to answer phone calls outside of working hours.

We placed public notice in Hertfordshire Mercury - I include the link below to our public notice placed within this newspaper.

<https://www.inyourarea.co.uk/notices/Other/Notice-of-Application-for-a-New-Premises-Licence-under-the-Licensing-Act-2003/79336492-2428-4794-ac26-f88920573e6a>

I will be in the meeting from now onwards and will be able to give you a call this afternoon as soon as the meeting finishes if that works for you?

Many thanks.

Kind regards
Assel

From: Denise Bastick <dbastick@eppingforestdc.gov.uk>
Sent: 18 October 2019 10:22
To: Assel England <assel@frc-group.co.uk>
Subject: New Premises Licence Application - Green's Steakhouse, 3 Centric Parade, 200 High Road, Loughton

Good morning

I would be grateful if you could please confirm the name of the local newspaper which contained the Public Notice and also forward a copy of it. We include a copy of the newspaper advert in our Report for the Licensing Sub-Committee hearing.

I would also be grateful if you could please call me to discuss the outside seating. I couldn't get through to you on your mobile earlier this morning.

Kind regards.

Denise Bastick
Licensing Compliance Officer
Commercial and Regulatory Service Directorate
dbastick@eppingforestdc.gov.uk

Tel: 01992 564334

Working hours Wednesday – Friday

Please contact Mrs Handan Ibrahim, Licensing Compliance Officer

hibrahim@eppingforestdc.gov.uk Tel: 01992 564153

Monday – Wednesday



DISCLAIMER

This email is for the use of the intended recipients only. Any opinion or advice it contains is that of the sender and does not bind the authority in any way. If you have received it in error, please notify the sender immediately and then delete the message. If you are not the intended recipient you must not use, disclose, copy or distribute this email. We have taken precautions to minimise the risk of transmitting software viruses, but we advise that you carry out your own virus checks on an attachment to this message. We cannot accept liability for any loss or damage caused by software viruses.

Internet email is not a secure communication medium, and we advise that you observe this lack of security when emailing us.

Epping Forest District Council

Postmaster@Eppingforestdc.gov.uk

Notices > Notices Near Undefined >

[View map](#)

Notice of Application for a New Premises Licence under the Licensing Act 2003

Notice of Application for a New Premises Licence under the Licensing Act 2003

Notice is given this day 19th September 2019 that Green's Loughton Ltd of 3 Centric Parade, 200 High Road, Loughton, IG10 1DN has applied to the Licensing office of Epping Forest District Council for a Premises Licence in respect of Green's Steakhouse & Grill at 3 Centric Parade, 200 High Road, Loughton, IG10 1DN. The proposed licence is for:

- Sale of alcohol and provision of recorded music on the premises Monday to Sunday between 08:00 and 00:00
- Provision of live music on the premises Monday to Sunday between 11:00 and 00:00
- Provision of late night refreshment on the premises Monday to Sunday between 23:00 and 00:00
- Hours Premises are Open to the Public – Monday to Sunday 08:00 to 00:30
- Non-standard timings: Sale of alcohol, Provision of recorded music, Provision of late night refreshment and Opening hours to be:

(1) From the end of permitted hours on Christmas Eve to the start of permitted hours on Christmas Day; and

(2) From the end of permitted hours on New Year's Eve to the start of permitted hours on New Year's Day

The register of licensed premises is maintained at the Licensing Office of Epping Forest District Council, Civic Offices, High Street, Epping, Essex, CM16 4BZ. Applications for premises licences may be inspected at this office during office hours.

Anyone wishing to oppose this application must give written notice to the Licensing Office within 28 days of this notice.

Notice of Application
for a New Premises Licence
under the Licensing Act 2003

Notice is given this day 19th September 2019 that Green's Loughton Ltd of 3 Centric Parade, 200 High Road, Loughton, IG10 1DN has applied to the Licensing office of Epping Forest District Council for a Premises Licence in respect of Green's Steakhouse & Grill at 3 Centric Parade, 200 High Road, Loughton, IG10 1DN.

The proposed licence is for:

- Sale of alcohol and provision of recorded music on the premises Monday to Sunday between 08:00 and 00:00
- Provision of live music on the premises Monday to Sunday between 11:00 and 00:00
- Provision of late night refreshment on the premises Monday to Sunday between 23:00 and 00:00
- Hours Premises are Open to the Public – Monday to Sunday 08:00 to 00:30
- Non-standard timings: Sale of alcohol, Provision of recorded music, Provision of late night refreshment and Opening hours to be:
 - (1) From the end of permitted hours on Christmas Eve to the start of permitted hours on Christmas Day; and
 - (2) From the end of permitted hours on New Year's Eve to the start of permitted hours on New Year's Day

The register of licensed premises is maintained at the Licensing Office of Epping Forest District Council, Civic Offices, High Street, Epping, Essex CM16 4BZ. Applications for premises licences may be inspected at this office during office hours. Anyone wishing to oppose this application must give written notice to the Licensing Office within 28 days of this notice.

It is an offence knowingly or recklessly to make a false statement in connection with an application which could lead to a fine on summary conviction (maximum £5000).



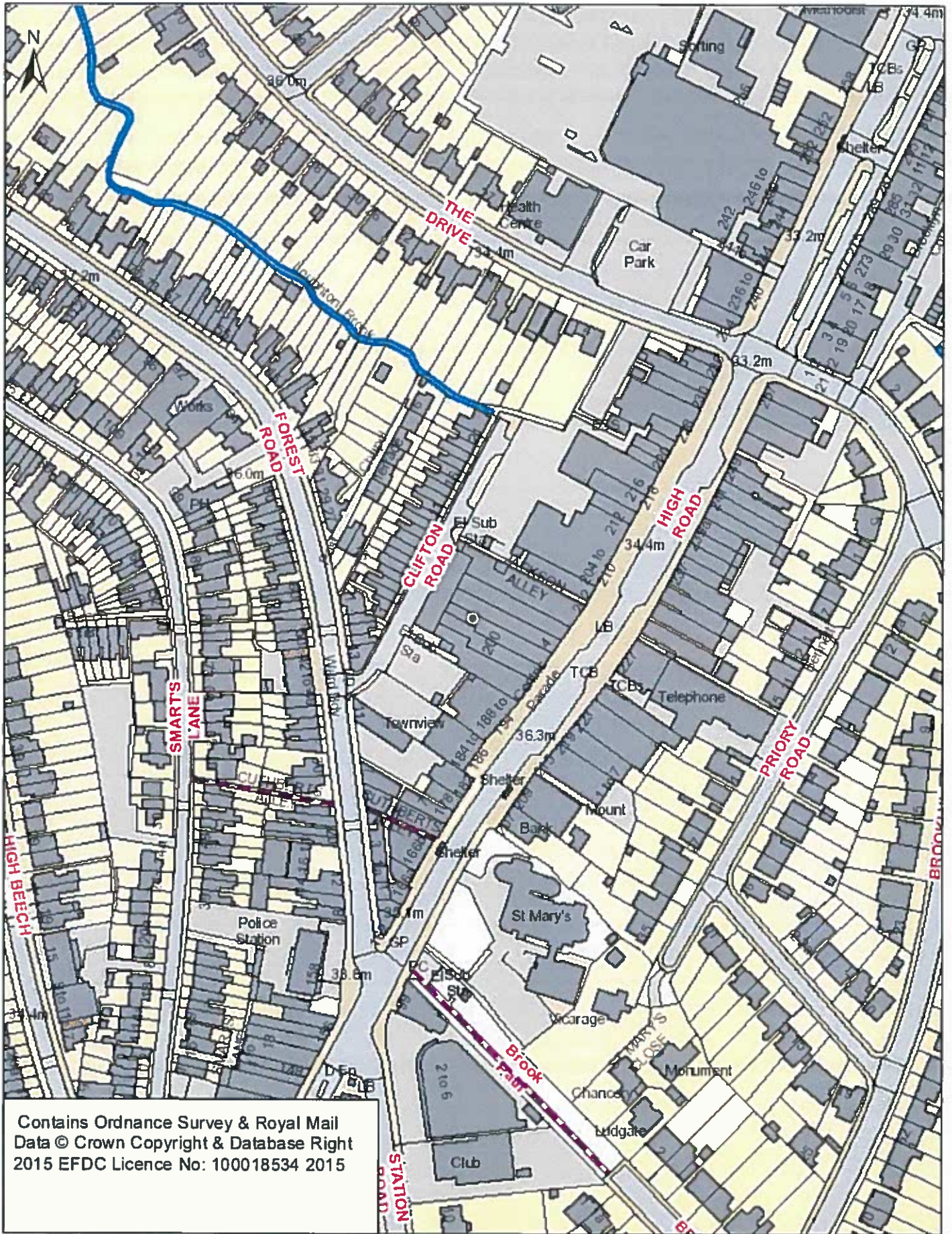

Denise Bastick

From: Debra Paris <[REDACTED]>
Sent: 02 October 2019 15:56
To: Handan Ibrahim; Denise Bastick
Subject: Planning & Licensing Committee Comments

CAUTION: This Message originated outside of Epping Forest District Council. Do not click links or open attachments unless you recognise the sender and know the contents is safe.

Dear Handan/Denise

Please find below the comments of the Planning & Licensing Committee following its meeting on 30 September 2019, in respect of the following two licensing applications:

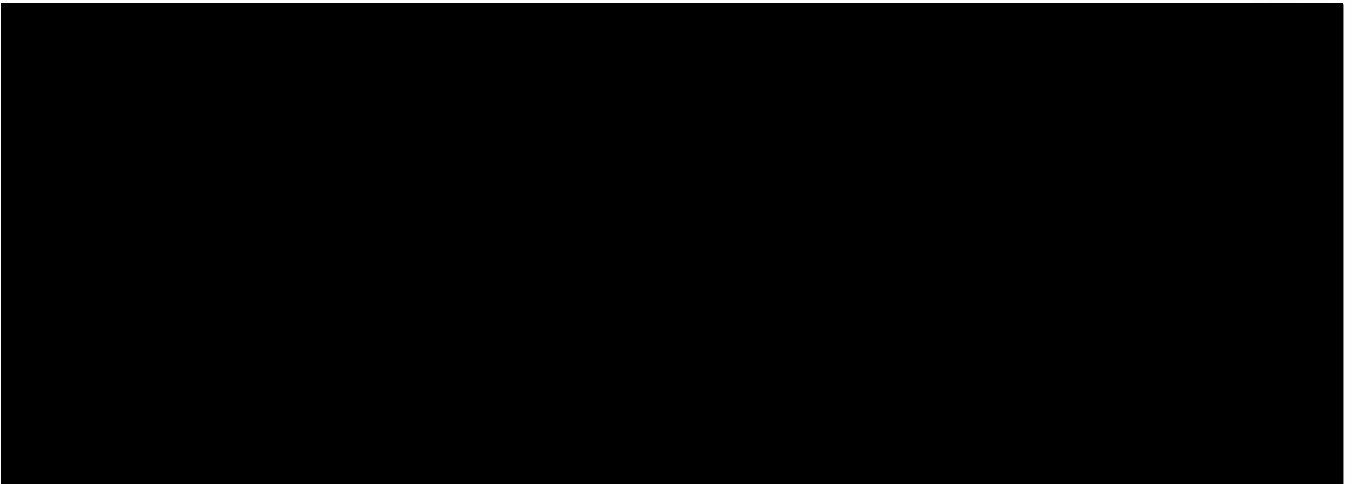

769.2 Notice of application to vary a Premises Licence under the Licensing Act 2003 in respect of Green's Steakhouse & Grill, 3 Centric Parade, 200 High Road, Loughton, IG10 1DN
The Committee NOTED the contents of a letter of objection.

The Committee OBJECTED to this proposed licensing application on the grounds of the prevention of crime and disorder and the prevention of public nuisance, confirming that the property had residential accommodation in close proximity and the occupants would be adversely affected by the late operation of this licence.

If Epping Forest District Council, Licensing Unit, is minded to grant this licence the Committee requested that the hours for the sale of alcohol and provision of late night refreshment be limited to 11pm Sunday to Thursday, and 12pm Friday to Saturday; and for no recorded or live music to be audible outside the premises after 9pm Sunday to Thursday and 10pm Friday to Saturday.

I would be most grateful if you could confirm receipt of this email and its contents.

Kind regards
Debra Paris
Planning and Licensing Committee Clerk Loughton Town Council
Loughton Library & Town Hall, Traps Hill, Loughton, IG10 1HD
Tel: 020 8508 4200
Fax: 020 8508 4400
E-mail contact@loughton-tc.gov.uk
Web: www.loughton-tc.gov.uk



COUNTDOWN TO CHRISTMAS

Denise Bastick

From: David Linnell [REDACTED]
Sent: 07 October 2019 11:20
To: Licensing
Subject: licensing application for Green's Steakhouse
Attachments: Licensing application, Green's Steakhouse 3 Centric Parade October 2019 letter to EFDC.doc

CAUTION: This Message originated outside of Epping Forest District Council. Do not click links or open attachments unless you recognise the sender and know the contents is safe.

Hi

I attach the LRA Plans Group comments on this application, which are also shown below.

regards

David Linnell
chairman, Loughton Residents Association Plans Group
+++++

Loughton Residents Association Plans Group



[REDACTED]
07 October 2019

[REDACTED]
Loughton,
Essex [REDACTED]

LICENSING APPLICATION, Green's Steakhouse, 3 Centric Parade, Loughton

We object to this application on the basis of the prevention of public nuisance.

This property has residential units nearby. There are flats above the shops on both sides of The High Road.

Under the provisions relating the prevention of public nuisance, we object to the proposed hours for opening, supplying alcohol and providing live or recorded music.

We think that 11pm is the latest that the business should be providing alcohol and any form of music and 11.30pm is the latest closing time which should be permitted.

Many residents will be in bed by 11pm, and most by midnight.

Even if the premises are well-sound-proofed,

- the noise of such customers - and their vehicles - leaving after 11.30pm, at a time when other daytime noises are much reduced, would obviously disturb High Road residents
- similarly, after the premises close, the noise of such customers - and their vehicles - leaving some time after closing time, at a time when other daytime noises are much reduced, would obviously disturb High Road residents.

If the Licensing sub-committee intend to approve the application, then we urge them to impose earlier licensing hours.

Yours sincerely

A solid black rectangular box used to redact the signature of David Linnell.

David Linnell, for LRA Plans Group.

Loughton Residents Association Plans Group



[REDACTED]
07 October 2019

[REDACTED]
Essex [REDACTED]

LICENSING APPLICATION, Green's Steakhouse, 3 Centric Parade, Loughton

We object to this application on the basis of the prevention of public nuisance.

This property has residential units nearby. There are flats above the shops on both sides of The High Road.

Under the provisions relating the prevention of public nuisance, we object to the proposed hours for opening, supplying alcohol and providing live or recorded music.

We think that 11pm is the latest that the business should be providing alcohol and any form of music and 11.30pm is the latest closing time which should be permitted.

Many residents will be in bed by 11pm, and most by midnight.

Even if the premises are well-sound-proofed,

- the noise of such customers - and their vehicles - leaving after 11.30pm, at a time when other daytime noises are much reduced, would obviously disturb High Road residents
- similarly, after the premises close, the noise of such customers - and their vehicles - leaving some time after closing time, at a time when other daytime noises are much reduced, would obviously disturb High Road residents.

If the Licensing sub-committee intend to approve the application, then we urge them to impose earlier licensing hours.

Yours sincerely

[REDACTED]
David Linnell, for LRA Plans Group.

Denise Bastick

From: Penny James [REDACTED]
Sent: 16 October 2019 14:48
To: Licensing
Subject: PLANNING APPLICATION REPRESENTATION - GREEN'S LOUGHTON LTD
Attachments: [REDACTED] APPLICATION REPRESENTATION.docx

CAUTION: This Message originated outside of Epping Forest District Council. Do not click links or open attachments unless you recognise the sender and know the contents is safe.

I would like to submit a representation for the planning application made by Green's Loughton Ltd. I have attached my written submission with all the details to this email. Please let me know by the end of today that you have received my representation.

Many thank,
Penny James

Sent from Outlook

Received via email 16.10.19

[REDACTED]
Loughton, Essex, [REDACTED]

To whom it may concern,

We are writing to make a representation on, and to object to, an application made by Green's Loughton Ltd, on 19th September 2019, at the address Green's Steakhouse & Grill, 3 Centric Parade, 200 High Road, Loughton, Essex, IG10 1DN, Ref: WK/201931642.

As residents of [REDACTED] High Road, the venue in the application is directly opposite our flat. We are extremely concerned about the **adverse effect on the residential amenity of neighbours** which will be caused by **noise, disturbance and public nuisance** from the proposed licences of the venue. We believe this will be caused because of the license requested to allow the provision of live music, recorded music, supply of alcohol, and late night refreshment **until midnight everyday of the week**. As well as that, the venue has requested a licence for the premises to be open until 00:30 everyday of the week.

The provisions requested will generate **noise, disturbance and nuisance** to us, through the noise of late night live and recorded music, and intoxicated people entering and leaving the venue, with the potential for this to happen every single day of the week, excessively, and **most importantly at night, until 00:30**.

Noise beyond 11pm can be considered a **public nuisance** by law in the public nuisance common law offence, where an act or failure to act adversely affects the comfort or quality of life of the public generally or a class of citizens, and by the private nuisance common law tort by causing substantial interference by the owner or occupier of a property with the use and enjoyment of neighbouring premises. In the case of *Andreae v Selfridge and Co. Ltd, 1938*, it was found the defendant had caused disturbance at unreasonable hours and therefore **the duty was to take precautions, including restricting the hours of disturbance**. Therefore we request restricting the hours of the licences for live music, recorded music, supply of alcohol, and late night refreshment, as well as the hours the premises can be open – to ensure precautions are taken to avoid causing public or private nuisance by law.

The noise, disturbance and nuisance has the potential to interrupt our peace **at night**, and as a result can affect sleeping properly. The same noise and disturbance that will affect us will also affect the six other flats in our building, and the many more flats immediately surrounding us on both sides of the high road. Therefore, **the licence requests for this venue are not in the public interest**.

Yours Faithfully,

Penny James, Monica Rowley

Scott Crawford and Alex Kite

[REDACTED]
Loughton [REDACTED]

12 October 2019

Epping Forest District Council
Licensing Unit, Civic Offices
High Street
Epping, Essex
CM16 4BZ

Your ref: WK/201931642

Dear sir or madam,

We write to object to the recent license application from Green's Loughton Limited regarding *Green's Steakhouse and Grill*, at 3 Centric Parade, 200 High Road in Loughton. We have several grounds for objection to the proposal:

- Prevention of crime and disorder,
- Prevention of public nuisance, and
- Protection of children from harm

Please note this location is closely surrounded by many residential properties, including several families such as ours, with young children. In such a setting, the request for live music, recorded music, or the sale of alcohol until midnight every night would each be completely inappropriate. Taken together, they are an outrage.

We know that late night drinking of the sort proposed will inevitably cause significant noise and disturbance to the residential neighbours - both while the drinking continues and as the inebriated patrons leave the premises. If you add in the noise and nuisance of music at these late hours, the nuisance, harm, and disorder to neighbouring families becomes intolerable. Are the young children in these homes supposed to sleep *after midnight*?

Please note there is precedent through a combination of licensing and planning restrictions that nearby properties are not allowed to operate or sell alcohol after 23:00 on any night of the week – and no nearby premises has a music license. To allow this application would not only be a nightmare for the residents, it would also be unfair as it is wholly inconsistent with restrictions based on neighbouring businesses.

To add insult to injury, the applicants request not just the noise, nuisance, and disorder on ordinary weeks until midnight, but also on Christmas and New Year's eve, they request these *all night long!* This shows great disregard, and a degree of contempt for the objectives of the licensing regime. It suggests inebriated crime and disorder would come rather than Santa on Christmas Eve.

Please reject this proposal outright. Given the wholly inappropriate request made, and the level of contempt it betrays, we also believe the committee should consider whether such an applicant would be appropriate for any alcohol or music license whatsoever.

Thank you for your consideration.

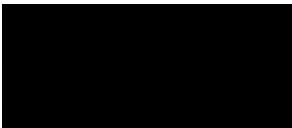

Alex Kite (Mr)

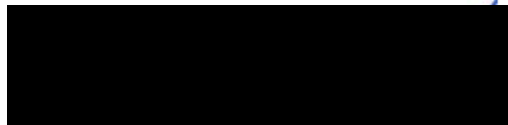

Scott Crawford (Mr) 

Denise Bastick

From: Licensing Epping and Brentwood
<licensing.epping.and.brentwood@essex.police.uk>
Sent: 03 October 2019 08:48
To: Assel England
Cc: Licensing; loughton@greenssteakhouse.com; Brad Green; Pavel Korolev; Victor Maksimuk
Subject: RE: Green's Steakhouse & Grill, Loughton - Premises Licence Application

CAUTION: This Message originated outside of Epping Forest District Council. Do not click links or open attachments unless you recognise the sender and know the contents is safe.

Thank you for your reply. I can confirm that Essex Police make no formal representations in respect of the application.

Kind regards,

Peter

From: Assel England <assel@frc-group.co.uk>
Sent: 02 October 2019 15:51
To: Licensing Epping and Brentwood <licensing.epping.and.brentwood@essex.police.uk>
Cc: EFDC Licensing <licensing@eppingforestdc.gov.uk>; loughton@greenssteakhouse.com; Brad Green
Subject: RE: Green's Steakhouse & Grill, Loughton - Premises Licence Application

Dear Mr Jones,

Thank you for your email and a schedule of recommended conditions. We have reviewed the schedule - Green's Loughton Ltd have no objections to the recommended conditions and we are happy for them to be included into our premises licence.

Kind regards

Assel England
Paralegal

Food and Restaurants Company Ltd | Correspondence address: 4 High Street, Bracknell, Berkshire, RG12 1AA
T: +44 (0) 1344 305 296 | E: assel@frc-group.co.uk

This email and any attachments to it may be confidential and are intended solely for the use of the individual to whom it is addressed. Any views or opinions expressed are solely those of the author and do not necessarily represent those of FRC Ltd or any of its subsidiaries. If you are not the intended recipient of this email, you must neither take any action based upon its contents, nor copy or show it to anyone. Kindly contact the sender if you believe you have received this email in error.

From: Licensing Epping and Brentwood <licensing.epping.and.brentwood@essex.police.uk>
Sent: 30 September 2019 14:21
To: Assel England <assel@frc-group.co.uk>
Cc: EFDC Licensing <licensing@eppingforestdc.gov.uk>
Subject: Green's Steakhouse & Grill, Loughton - Premises Licence Application

Dear Sir/Madam,

I am currently looking at your application for a premises licence and have drawn up a schedule of recommended conditions to promote the licensing objectives I seek to agree with you. Please take the time to consider the below; and respond whether you are happy to accept or not; or even if you wish to negotiate.

Prevention of Crime and Disorder

1. The premises shall have installed and maintain a closed circuit television surveillance (CCTV) system which at all times complies with the below requirements:
 - i. CCTV will be provided in the form a recordable system, capable of providing pictures of evidential quality in all lighting conditions particularly facial recognition;
 - ii. CCTV cameras shall cover all public areas including all entrances and exits and all areas where the sale of alcohol takes place;
 - iii. Equipment must be maintained in good working order, be correctly time and date stamped, recordings must be kept in good working order and kept for a minimum period of 31 days;
 - iv. Upon the reasonable request of the police or licensing authority staff, within 48 hours viewable copies of recordings will be provided.
2. Signs must be displayed at all entrances and exits advising customers that CCTV is operating at the premises and shall be a minimum size of 200 x 148 mm and clearly legible at all times when the premises conducts licensable activities.
3. After 20:00 every day there shall be a personal licence holder on duty on the premises when alcohol is offered for sale.
4. No alcohol may be supplied by an individual unless that individual has the written consent of the Designated Premises Supervisor or other employed Personal Licence Holder. A written record of this consent must be retained on the premises at all times when such an individual supplies or proposes to supply alcohol and be made available immediately upon reasonable request of the police or licensing authority.
5. In addition to water, other non-alcoholic beverages shall be available at all times whilst alcohol sale or supply takes place
6. Substantial food and non-intoxicating beverages shall be available in all parts of the premises where alcohol is sold or supplied for consumption on the premises at all times.

Public Safety

7. At all times no persons shall be permitted to take bottles, glasses or drinking vessels from the premises. Conspicuous signage of a minimum size of 200mm x 148 mm shall be displayed, at each ingress/egress point explaining this policy.

Prevention of Public Nuisance

8. Except when being used for entry or egress by a patron, all external windows and doors shall be kept shut when music is being played after 22:00 hours.
9. The premises must operate as a restaurant:
 - i. In which customers must be seated at a table;
 - ii. Which provides substantial table meals that are prepared on the premises and are served and consumed at the table.
 - iii. Which do not provide any take away service of food or drink for immediate consumption; and
 - iv. Where alcohol must not be sold, supplied, or consumed on the premises otherwise than to persons who are taking substantial table meals and provided always that the consumption of alcohol by such persons is ancillary to taking such meals.

10. Service of alcohol shall be by waiter/waitress only to patrons seated at a table and who have or intend to have a substantial meal.
11. No persons shall be supplied with alcohol at a bar or place of similar description within or outside the premises.

Protection of Children from Harm

12. A Challenge 25 scheme shall be operated, whereby any person who appears to be under the age of 25 years of age is required to produce on request an item which meets the mandatory age verification requirement **and** is either a:
 - Proof of age card bearing the PASS Hologram;
 - Photocard driving licence;
 - Passport; or
 - Ministry of Defence Identity Card.
13. The premises shall clearly display signs advising customers that a 'Challenge 25' policy is in force.
14. A refusals record shall be maintained at the premises which details all refusals to sell alcohol. Each entry shall, as a minimum, record the date and time of the refusal and the name of the staff member refusing the sale. All entries must be made as soon as possible and in any event within 4 hours of the refusal and the record must be made immediately available to police, trading standards or licensing authority staff upon reasonable request. The refusals record shall either be electronic or maintained in a bound document and retained for at least 12 months from the date of the last entry.
15. All staff engaged in the sale or supply of alcohol on the premises shall have received training in relation to the protection of children from harm (including under-age sales), how to recognise drunkenness and the duty not to serve drunk persons. Refresher training shall be carried out at least every six months. Training records shall be kept on the premises (or otherwise be accessible on the premises) for a minimum of 12 months and made immediately available to police, trading standards or licensing authority staff upon reasonable request.

I look forward to hearing from you.



Peter Jones (7706) MIOL MBII
Licensing Officer – Epping Forest & Harlow
☎ 01279625405 (Ext: 313604) [REDACTED]
📍 Loughton Police Station, 158 High Road, Loughton, IG104BE

This email and any other accompanying document(s) contain information from Kent Police and/or Essex Police, which is confidential or privileged. The information is intended to be for the exclusive use of the individual(s) or bodies to whom it is addressed. The content, including any subsequent replies, could be disclosable if relating to a criminal investigation or civil proceedings. If you are not the intended recipient, be aware that any disclosure, copying, distribution or other use of the contents of this information is prohibited. If you have received this email in error, please notify us immediately by contacting the sender or telephoning Kent Police on 01622 690690 or Essex Police on 01245 491491, as appropriate. For further information regarding Kent Police's or Essex Police's use of personal data please go to <https://www.kent.police.uk/policy/privacy,-cookies-and-legal-notice/> or <https://www.essex.police.uk/copyright-privacy/>

This email and any other accompanying document(s) contain information from Kent Police and/or Essex Police, which is confidential or privileged. The information is intended to be for the exclusive use of the individual(s) or bodies to whom it is addressed. The content, including any subsequent replies, could be disclosable if relating to a criminal investigation or civil proceedings. If you are not the intended recipient, be aware that any disclosure, copying, distribution or other use of the contents of this information is prohibited. If you have received this email in error, please notify us immediately by contacting the sender or telephoning Kent Police on 01622 690690 or Essex Police on 01245 491491, as appropriate. For further

Denise Bastick

From: Christopher Smith
Sent: 30 September 2019 08:37
To: Licensing; Denise Bastick; Handan Ibrahim
Subject: FW: Ref. WK/201931723

Please see below

From: Assel England [<mailto:assel@frc-group.co.uk>]
Sent: 25 September 2019 11:26
To: Christopher Smith <CSmith@eppingforestdc.gov.uk>
Cc: Victor Maksimuk [REDACTED]; Brad Green [REDACTED]
Subject: RE: Ref. WK/201931723

CAUTION: This Message originated outside of Epping Forest District Council. Do not click links or open attachments unless you recognise the sender and know the contents is safe.

Dear Mr Smith,

Thank you for your representation - we are happy for the conditions suggested by you to be included into our Premises Licence.

Thank you.

Kind regards

Assel England
Paralegal

From: Christopher Smith <CSmith@eppingforestdc.gov.uk>
Sent: 24 September 2019 13:22
To: Assel England <assel@frc-group.co.uk>
Subject: CPO0

Dear Mr Viktor Maksimuk,

Please find attached a copy of my letter dated 24/09/2019 raising my representation.

A paper copy has also be sent today for your files.

Regards

Chris Smith
Environmental Enforcement Officer
Community and Partnerships Directorate

Email: csmith@eppingforestdc.gov.uk
Tel. (Direct): 01992 564160 Contact Centre: 01992 564608
Epping Forest District Council, Civic Offices, High Street, Epping, Essex, CM16 4BZ

Date: 24 September 2019

Mr Vikta Maksimuk
3 Centric Parade
200 High Street
Loughton
IG10 1DN

Civic Offices
High Street
Epping
Essex
CM16 4BZ

Our Ref: WK/201931723
Your Ref:

Licensing Act 2003

Green's Steakhouse & Grill, 3 Centric Parade, 200 High Road, Loughton, Essex, IG10 1DN

Dear Mr Vikta Maksimuk

On behalf of the Council's Environment & Street Scene Directorate, I confirm receipt of a copy of your application that I received on 19th September 2019 regarding the above mentioned property, in relation to the Licensing objective the Prevention of Public nuisance.

I have made the following representation to the Council's Licensing Section with regard to the Licensing objective – Prevention of Public nuisance:

1. Use of the outside area

I am concerned about the potential impact of the proposed use of the outside area on those residents that live above the stores along the High Road. I believe that the use of the area should be restricted to minimise the amount of disturbance caused.

In order to minimise the disturbance I would recommend that the following conditions should be added to the operating schedule:

The outside seating area shall not be open to customers for eating or drinking outside after 22.00 hours.

Reason – In order to prevent a public nuisance to nearby residents.

As the outside area will be used by smokers after 22.00 hours the following condition should also apply:

Between 22.00 hours and the when the premise is closed to the public, the outside area shall only be used by customers to smoke. No food or drink to be taken/consumed in the outside area after 22.00 hours.

Reason – In order to prevent a public nuisance to nearby residents.

2. Noise from customers and inside the premises

I have concerns in relation to the amount of noise that the premise may generate both in terms

of customer noise and regulated entertainment. This noise could be significant therefore I would recommend the following is added to the operating schedule:

Window and doors shall be closed by 22.00 hours to minimise the noise from the premises, other than entry and exit of patrons.

The premises Supervisor (or representative) shall monitor the volume of music emanating the premises and adjust the volume to ensure that any amplified sound or other music from the licenced premises does not cause a public nuisance.

Reason – In order to prevent a public nuisance to nearby residents.

I would also recommend the following condition is added, to ensure that customers are aware of residents close by:

The manager and staff will encourage customers to leave quietly. The premises will post notices to enforce this and these notices are to be clearly visible at all times.

Reason – In order to prevent a public nuisance to nearby residents.

3. Hours of deliveries and refuse collections

The area to the rear of the premises is accessed by Clifton Road, Loughton. This road is a narrow residential road, which also acts as an access road for deliveries and refuse collections for the stores on the High Road. In order to protect the amenity of the area for local residents I would recommend the following condition.

No deliveries or refuse collections shall take place outside the hours of Monday to Saturday 07.30 to 19.30 nor at anytime on Sundays and Bank Holidays.

Reason – In order to protect amenity of the area and that of local residents.

If you would like to discuss the matter or have any written comments, please do not hesitate to contact me.

I should be happy to withdraw the representation(s) if the operating schedule is amended accordingly or if you agree to a suitable condition(s) being imposed as part of the licence, or if you provide sufficient evidence to confirm that the representation can be withdrawn.

Please confirm your comments in writing (by letter or email). I will inform the Council's Licensing Section if satisfied that the representation(s) can be withdrawn.

Yours faithfully

Chris Smith
Environmental Enforcement Officer
Tel No: (01992) 564160
Email: csmith@eppingforestdc.gov.uk
c.c. Licensing Section

Denise Bastick

From: Muhammad Rahman
Sent: 27 September 2019 09:21
To: Denise Bastick
Cc: Theresa Parker; Michael Johnson
Subject: RE: Application for a New Premises Licence - Green's Steakhouse & Grill, 3 Centric Parade, 200 High Street, Loughton, IG10 1DN

Importance: High

Dear Denise,

We OBJECT to the application.

The application site currently has permission to be open from 07:00 – 01:00 Monday to Saturday and 08:00 – 22:00 on Sundays and bank/public holidays, and is prohibited from using the area between the shopfront and the edge of the carriage way for outdoor seating area.

The proposed hours and outdoor space would be in breach of conditions 1, and 2 from EPF/1479/11, and therefore liable to enforcement action.

The applicants will need to either submit a new planning application or a variation of condition application.

Regards,

Muhammad Rahman

Planning Officer | Development Management | Planning Services

t 01992564415 | w www.eppingforestdc.gov.uk/planning-and-building/

Please note that advice is provided at officer level and in no way prejudices any future determinations made by the Local Planning Authority.

Please consider the environment before printing this e-mail

Epping Forest District Council | Civic Offices | High Street | Epping | Essex | CM16 4BZ

From: Michael Johnson
Sent: 26 September 2019 17:54
To: Muhammad Rahman <mrahman@eppingforestdc.gov.uk>
Cc: Theresa Parker <TParker@eppingforestdc.gov.uk>
Subject: FW: Application for a New Premises Licence - Green's Steakhouse & Grill, 3 Centric Parade, 200 High Street, Loughton, IG10 1DN

Muhammad,

Please check and advise. If there are material deviations from the approved use, then commentary will be needed for Licensing.

Kind regards,